

JUMONG RETRO COMFORT



SIMPLY GET YOUR DR UPGRADE DR SOLUTION WITH FLAT PANEL DETECTOR & SOFTWARE

Improve your workflow through immediate image acquisition

Friendly design for user comfort

SUPERIORITY

Wide image area, significantly reduced dead space

No Generator connection needed

No bucky modification needed

Single or dual flat panel detector for multi practice

EASY
GRIP

DURABILITY

LARGE
AREA

USEFUL
MOBILE
ENVIRONMENT

LIGHT
WEIGHT

AUTO
TRIGGER

WIRED/
WIRELESS

SYSTEM CONFIGURATION & SPECIFICATION

	1717 WIRED (CsI)	1717 WIRELESS (CsI)
Detector technology	Amorphous Silicon	
Scintillator	CsI	
Active area	427 × 427 mm	
Pixel matrix	3072 × 3072	
Pixel pitch	139 μm (100μm Is optional)	
Spatial resolution	3.6 lp/mm	
AD conversion	16 bit	
Trigger mode	AED / Software / Prep	AED / Software
Full image time	5 sec	
Preview image time	3 sec	2 sec
Data interface	GigE	2.4G and 5G IEEE802.11 a/b/g/n/ac
Battery operation time	n/a	5 h
Power consumption	30 w	16 w
Dimension	460 × 460 × 15 mm	
Weight	3 kg	3,5 kg
Operating temperature	5~35 ℃	
Operating humidity (% RH)	30~80 % RH (Non-Condensing)	10~90 % RH (Non-Condensing)
Storage temperature (℃)	-10~55 ℃	-20~55 ℃
Storage humidity(% RH)	10~90 % RH (Non-Condensing)	5~95 % RH (Non-Condensing)
Application	Medical / VET	

- Upgrade and options: Cable, Power unit, Battery charger

ADDITIONAL OPTION

Workstation	PC	I5 1TB HDD, 4GB RAM, WIN10
	Monitor	24" LED Monitor or Equivalent
	Input device	Keyboard and mouse / Integrated Generator Console

PACKING INFORMATION

	Jumong Retro	Jumong Retro(Including workstation)
Weight	15 kg	35 kg
Dimension	700 x 700 x 400	820 x 630 x 730

TECHNICAL DRAWING

- 1717 WIRED (CsI)

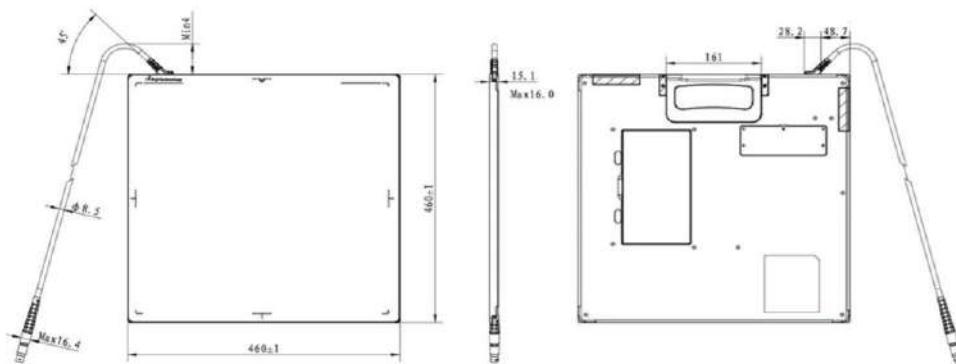

- 1717 WIRELESS (CsI)

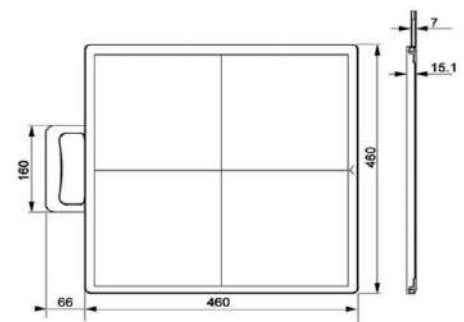

HQ: 113 Jungdae-Ro, Songpa-Gu, Seoul 05718, KOREA | Factory: 10, Yangnyeong-ro, Moga-myeon, Icheon-Si, Gyeonggi-Do, KOREA

US Office: 4801 Wilshire Blvd, Ste. 104 Los Angeles, CA 90010, USA | P +82 (0)2 449 6908 / +82 (0)2 449 6909 | E sales@sghealthcare.com | H www.sghealthcare.com